



# RHINO-RACK®

## RCP29-BK Pad Kit

ISUZU MU-X Gen1, ISUZU D-Max X-Terrain Gen3,  
Subaru Outback Touring

**Important:**

1. Check the Rhino-Rack website to ensure you have the latest issue of these instructions.
2. Please refer to your fitting instruction to ensure that the roof racks are installed in the correct locations.
3. Check the contents of kit before commencing fitment and report any discrepancies.
4. Place these instructions in the vehicle's glove box after installation is complete.
5. These instructions must be followed for warranty to be upheld.

**Fit Time:** 1 hour

**Layout:**

Note: Crossbars and legs sold as separate.

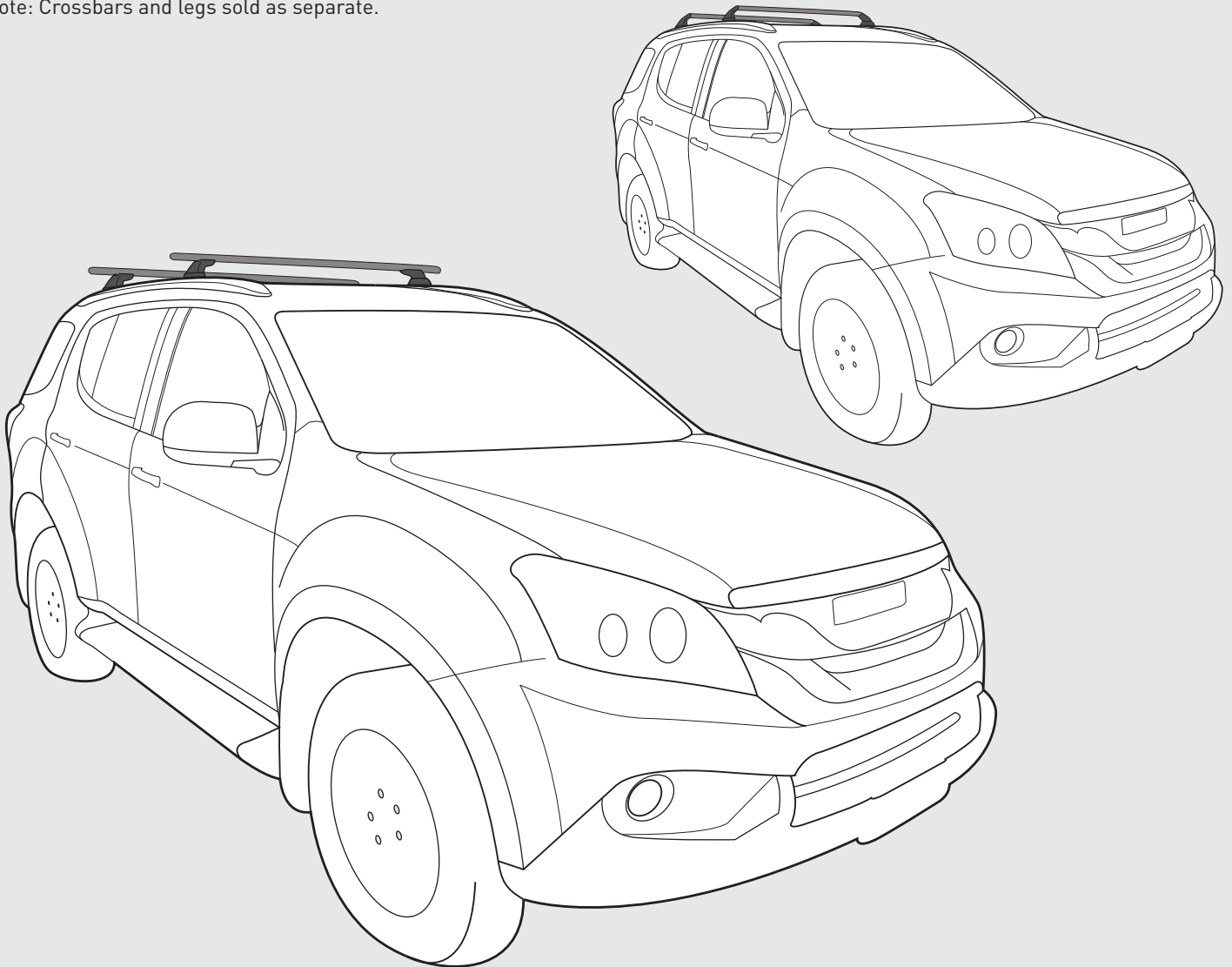

**Rhino-Rack**

22A Hanson Pl, Eastern Creek NSW 2766, Australia  
(02) 8846 1900  
rhinorack.com

Document No: R1335  
Issue No: 04  
Issue Date: 10/05/2021

# RCP29-BK Instructions

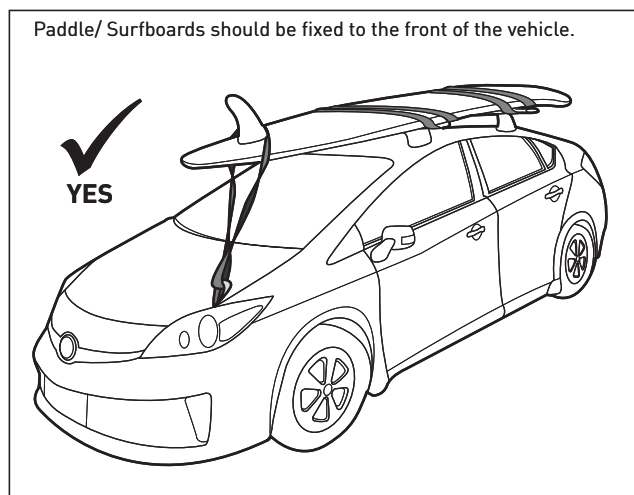
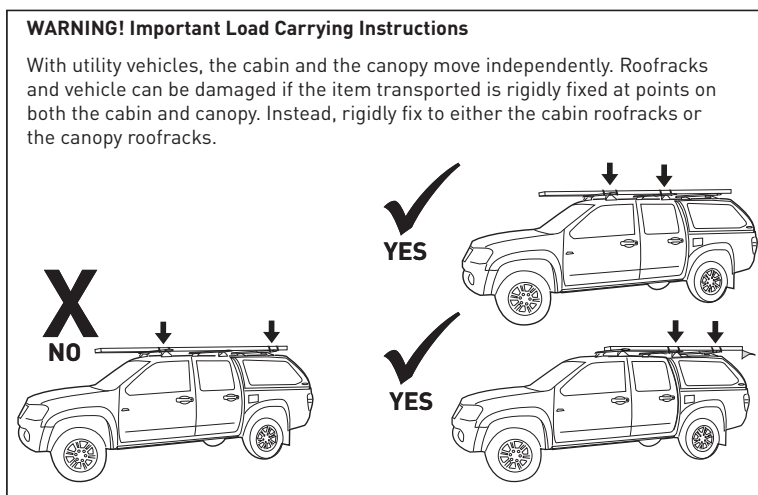
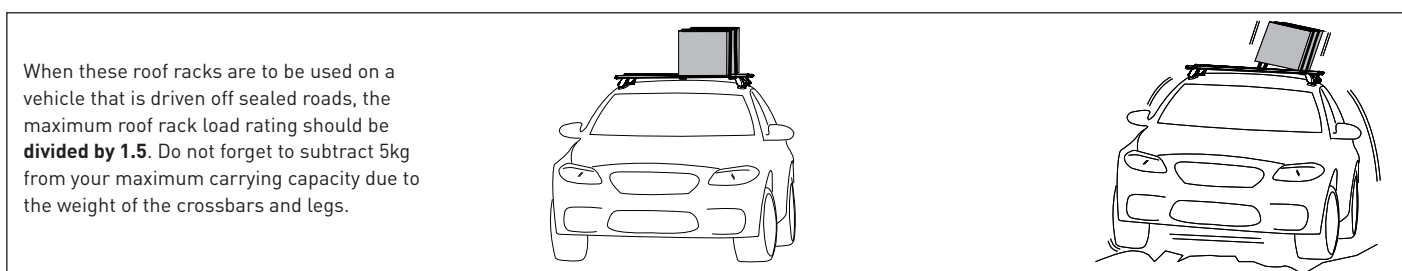
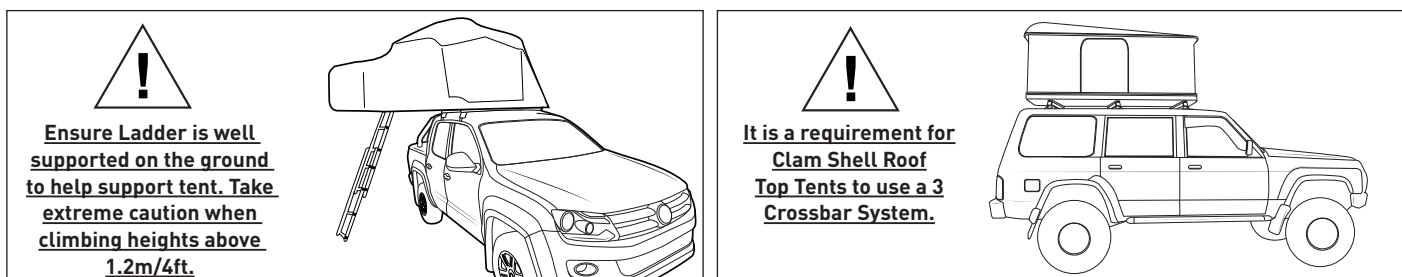
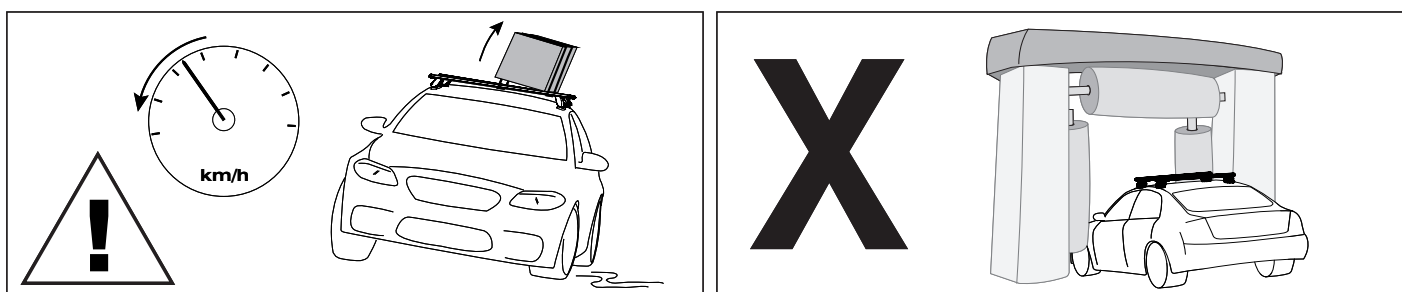
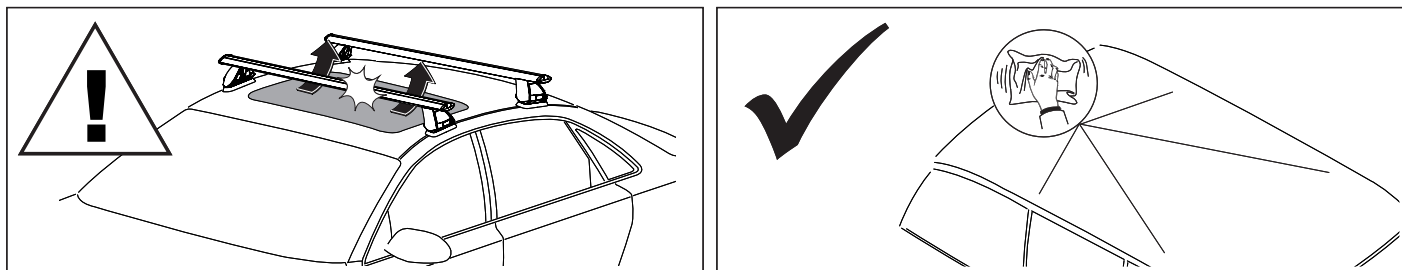
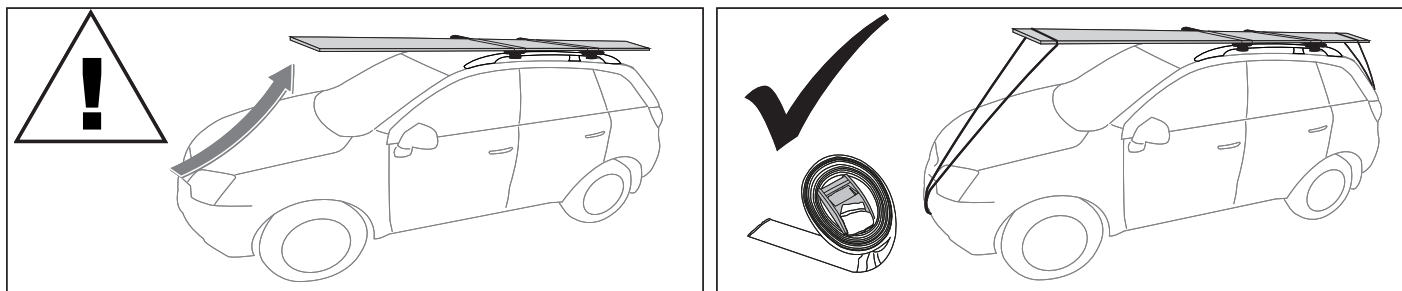

## RCP29-BK Instructions





### Carrying Capacity

Check the website and the vehicle owners hand book for your vehicle manufacturer's maximum carrying capacity. Load must be evenly distributed over the system.

VISIT THE ONLINE  
LOAD LIMIT  
CALCULATOR FOR  
CURRENT LOAD DATA

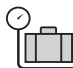

**DYNAMIC LOAD LIMIT:**  
**\*USE THE VEHICLE MANUFACTURER'S MAXIMUM ROOF ALLOWANCE IF IT IS LOWER THAN THE FIGURE LISTED**

 CARGO	 SYSTEM WEIGHT	 LOAD LIMIT	<b>OR</b>	 Max kg	
UP TO <b>55 KG</b> <b>121 lbs</b>	<b>+</b> <b>5 KG</b> <b>11 lbs</b>	<b>=</b>		UP TO <b>60 KG</b> <b>132 lbs</b>	<b>*VEHICLE MANUFACTURER'S ROOF LOAD LIMIT</b>



#### Cargo Load Limit

Total permissible weight allowed on top, and attached to roof racks whilst the vehicle is in motion.

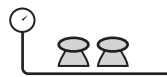

#### System Weight

Total weight of the roof rack system. (Crossbars, Backbone, Platform)



#### Max System Load Capacity

Please ensure you use the vehicle manufacturer's maximum roof allowance if it is lower than the figure listed in the fitting chart.



#### Vehicle Manufacturer's Load Limit

Total permissible weight attached to the roof of the car. This is inclusive of the weight of the roof rack system.

### Warning

- Check part number or kit is correct for use with your vehicle.
- Do not attempt to fit the rack system to your vehicle unless you fully understand these fitting instructions. Please direct any questions regarding fitting to the dealer from where the roof racks were purchased.
- Off-road conditions can be much more rigorous. Extreme care must be taken on any driven path that does not contain a surface protection layer (tar/bitumen).
- Roof racks must be removed when vehicle is put through an automatic car wash.
- With utility vehicles, the cabin and the canopy move independently. Roof racks and vehicle can be damaged if the item transported is rigidly fixed at points on both the cabin and canopy. Instead, rigidly fix to either the cabin roof racks or the canopy roof racks.
- Always ensure you fasten your load securely.
- Use only non-stretch fastening ropes or straps to attach cargo to your load.

### In service maintenance checks

- All bolt connections should be checked after driving a short distance when you first install your roof racks.
- All bolted connections should be checked again at regular intervals (weekly is recommended, depending on road conditions, usage, loads and distances travelled).
- All bolted connections should be checked each time they are re-fitted.
- Off-road conditions are more rigorous. Check all bolted connections and your load more regularly.
- Ensure that your vehicle manufacturer's GVM, and gross axle weights are not exceeded (refer to vehicle owner's manual).

#### Torque Settings

Unless stated otherwise in these instructions, all fasteners should be set to the following torque settings:

M6: 4-5Nm (3-4lbs/ft),

M8: 8-10Nm (6-7.5lbs/ft)

M10: 16-18Nm (12-13lbs/ft).

### Note for Dealers and Fitters

It is your responsibility to ensure these fitting instructions are given to the end user or client. These instructions remain the property of Rhino-Rack Australia Pty. Ltd. and may not be used or changed for any other purpose than intended.

# RCP29-BK Instructions

## Parts List

Item	Component Name	1 Bar	2 Bar
1	M6 x 40mm Hex Setscrew	2	4
2	M6 Spring Washer	2	4
3	M6 x 16mm Flat Washer	2	4
4	Top Pad	2	4
5	Base Pad	2	4
6	RLCP Bracket	2	4
7	Pad Cover	2	4
8	M6 Washer (used on cover plate)	2	4
9	Instruction	1	1

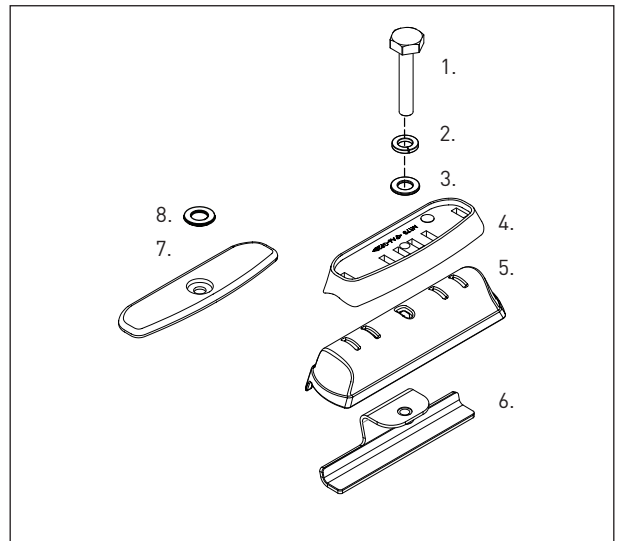

**Tools Required:** 10mm socket wrench.

1

The four top and bottom pads are identical. Diagram shows the correct orientation of top and bottom pad. The large cut out and lip of the bottom pad sits over the inside edge of the roof rail.

2

Use measurements below as a guide for positioning roof racks.

Use for:  
**D-MAX  
Gen3  
X-Terrain**

Use for:  
**MU-X,  
Outback  
Touring**

- 3** Place crossbars onto the pads. Place the stainless strap into the inside gap of the base pad. Insert the M6 x 40 hex and washer assembly through the leg and fasten. **Recheck measurements from step 2 and tighten the crossbars in place (3-4Nm).**

RVL crossbar shown as example only. M6 x 16mm flat washer used.

