

FITTING CHART - JEEP Wrangler JL 4dr 4WD with Backbone

PIONEER 42108B / 42108BF (Flat Pack) (1828 x 1426mm) (5' 11 31/32" x 4' 8 9/64")
PIONEER 45108B (1828 x 1426mm) (5' 11 31/32" x 4' 8 9/64")

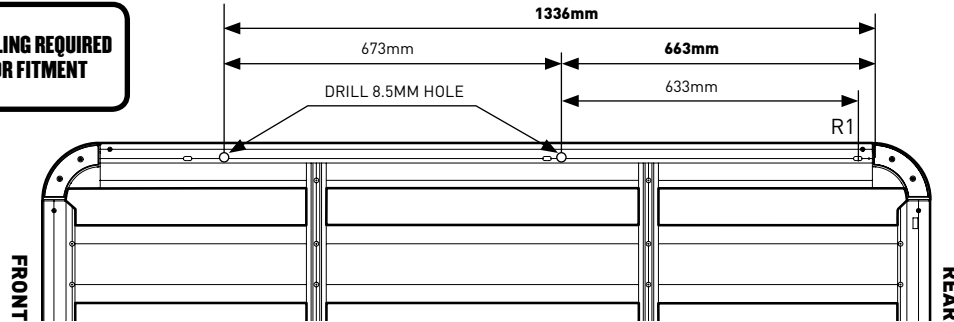

FRONT CROSSBAR		MIDDLE CROSSBAR		REAR CROSSBAR		ADDITIONAL HEIGHT ADDED TO VEHICLE WITH RACKS
FRONT SLOT	SPACER KIT	MIDDLE SLOT	SPACER KIT	REAR SLOT	SPACER KIT	
1336mm FROM REAR OF EXTRUSION	QMHD05	663mm FROM REAR OF EXTRUSION	QMHD05	R1	QMHD05	~115mm FROM HIGHEST POINT OF VEHICLE

COUNTRY	VEHICLE	RUNNING DATE	VEHICLE LOAD RATING (kg / lbs)	FIT KIT	IMPORTANT NOTES
Australia & NZ	JEEP Wrangler 4dr 4WD Hard Top JL with Backbone	2019 - on	120 / 265	1 x RJLB1 1 x RCL6 3 x QMHD05	Position the centreline of the Pioneer evenly between mounting points of RJLB1
USA & Canada	JEEP Wrangler JL 4dr SUV Hard Top with Backbone	2019 - on			

INSTALLATION NOTE

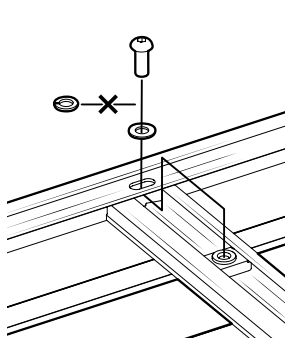

Remove the spring washer from the button head and channel nut assembly of the Pioneer underside bar. Re-install button head with flat washers only.

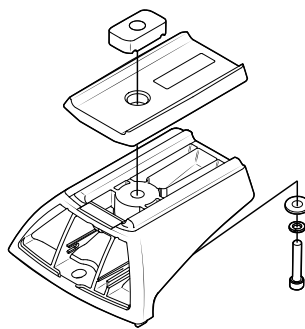

Combine RCL legs with QMHD05 spacer kits.

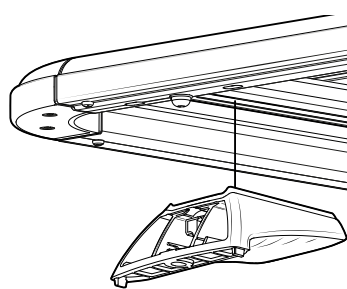

Attach leg assemblies to the Pioneer underside bars. Tighten leg hardware to a firm sliding fit.

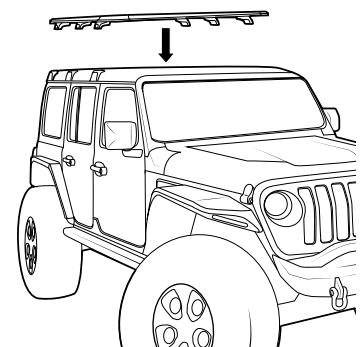

Place Pioneer assembly onto RJLB1 castings. Slide legs into position and attach to castings. Centre Pioneer between legs and tighten all hardware to final torque.

Note for Dealers and Fitters:

It is your responsibility to ensure these fitting instructions are given to the end user or client.

Rhino-Rack, 22 Hanson Pl, Eastern Creek

NSW 2766, Australia
 (02) 8846 1900
 rhinorack.com.au

Document No: R1870
 Issue No: 03
 Issue Date: 30/07/2019

These instructions remain the property of Rhino-Rack Australia Pty. Ltd. and may not be used or changed for any other purpose than intended.